

POMPE SOMMERGIBILI – SUBMERSIBLE PUMPS

TAUCHPUMPEN

P218



New Version
Lowest suction
1 mm

TELKA 26 - lowest suction - 270w - 230 v / 50 Hz

The new submersible pumps TELKA LOWEST SUCTION, with the new special body for minimum level suction is fruit of the careful study and re-project of the hydraulic circuit of the standard TELKA.

- Available in the same TELKA 26 pump casing - 270W - 230V/50HZ
- New version available in both MANUAL and GI INCORPORATED FLOAT execution
- Suitable for clean water containing particles up to 1 mm diameter
- It can pump out water down to 1 mm
- In the manual position the pump is self-priming starting from 1mm water level
- Provided as standard components with SPECIAL FIXING FEETS, which give you the possibility to rise the pump body of approximately 4-5mm for passage of solids up to of 4-5mm diameter.

Hydraulic characteristics of the 1mm lowest suction version are slightly lower than the normal versions

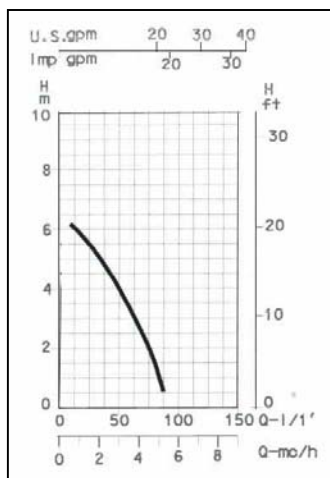

**LOWEST SUCTION
VERSION 1 mm**

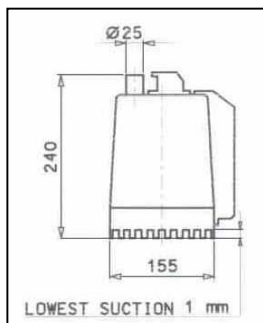

**NORMAL
VERSION 4,5 mm**

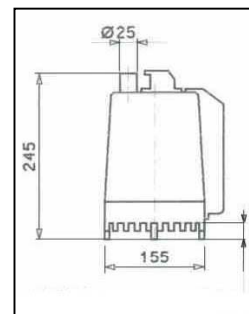

SIMACO reserves the right to make modifications without prior notice



Fluid moving technology

SIMACO ELETTROMECCANICA s.r.l.